



**ZONING  
ORDINANCE  
OF THE  
TOWN OF  
RUSHFORD**

Effective 2013

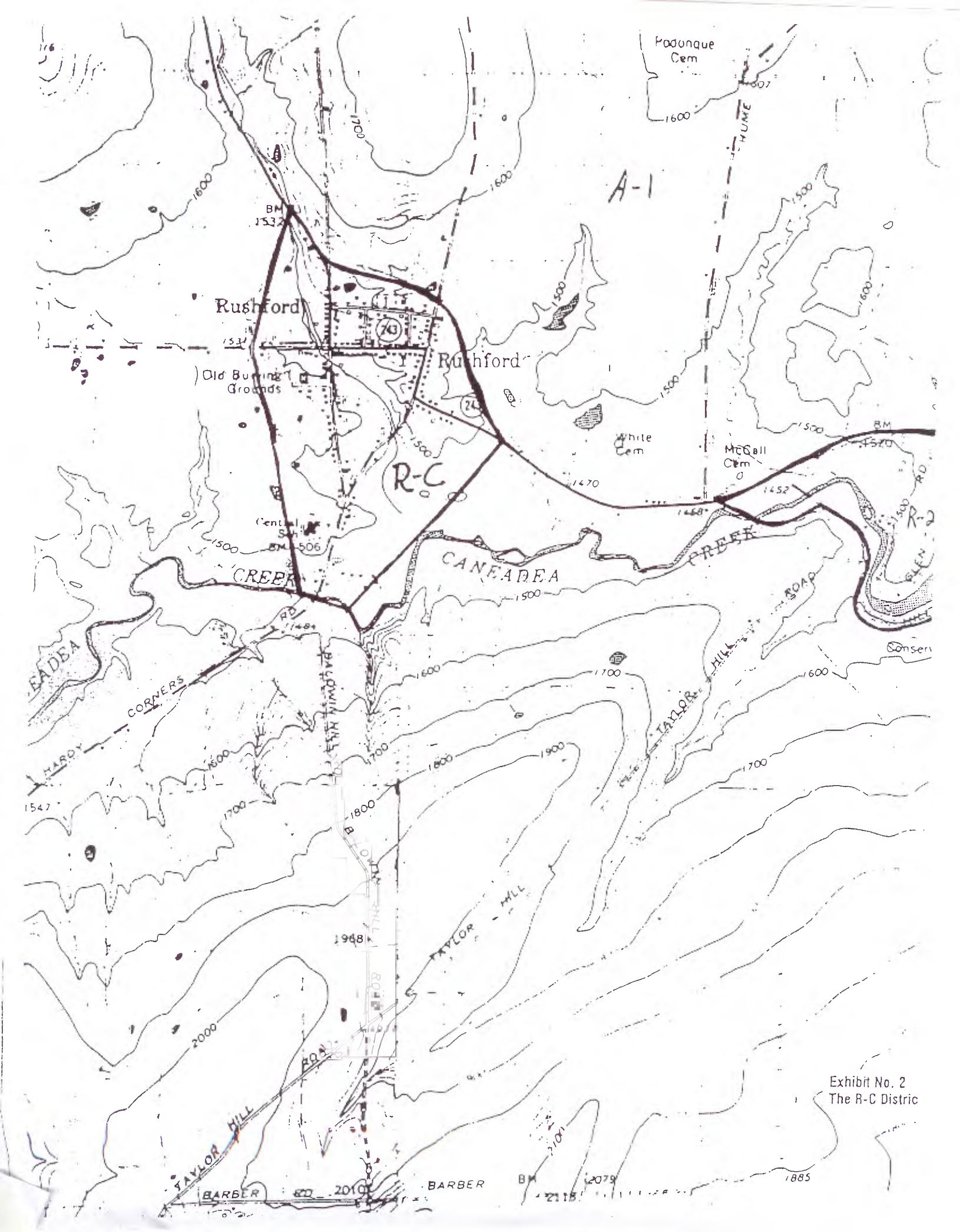

Exhibit No. 2  
The R-C District

## **ZONING ORDINANCE**

**Town of Rushford  
Allegany County  
State of New York**

### ***ARTICLE 1 - SHORT TITLE***

This ordinance shall be known and may be cited as the “Zoning Ordinance of the Town of Rushford, Allegany County, State of New York.

### ***ARTICLE 2 - INTENT AND PURPOSE***

For the purpose of promoting the public health, safety, morals, comfort and general welfare; conserving and protecting property values; securing the most appropriate use of land; and facilitating adequate but economical provision of public improvements, the Town Board of Rushford finds it necessary and advisable to regulate the location, size, and use of buildings and other structures; percentages of lot area which may be occupied, setback building lines; sizes of yards, courts and other open spaces; and the use of land for trade, industry, residences, recreation, or other purposes, and for such purpose, divides the Town of Rushford into districts or zones.





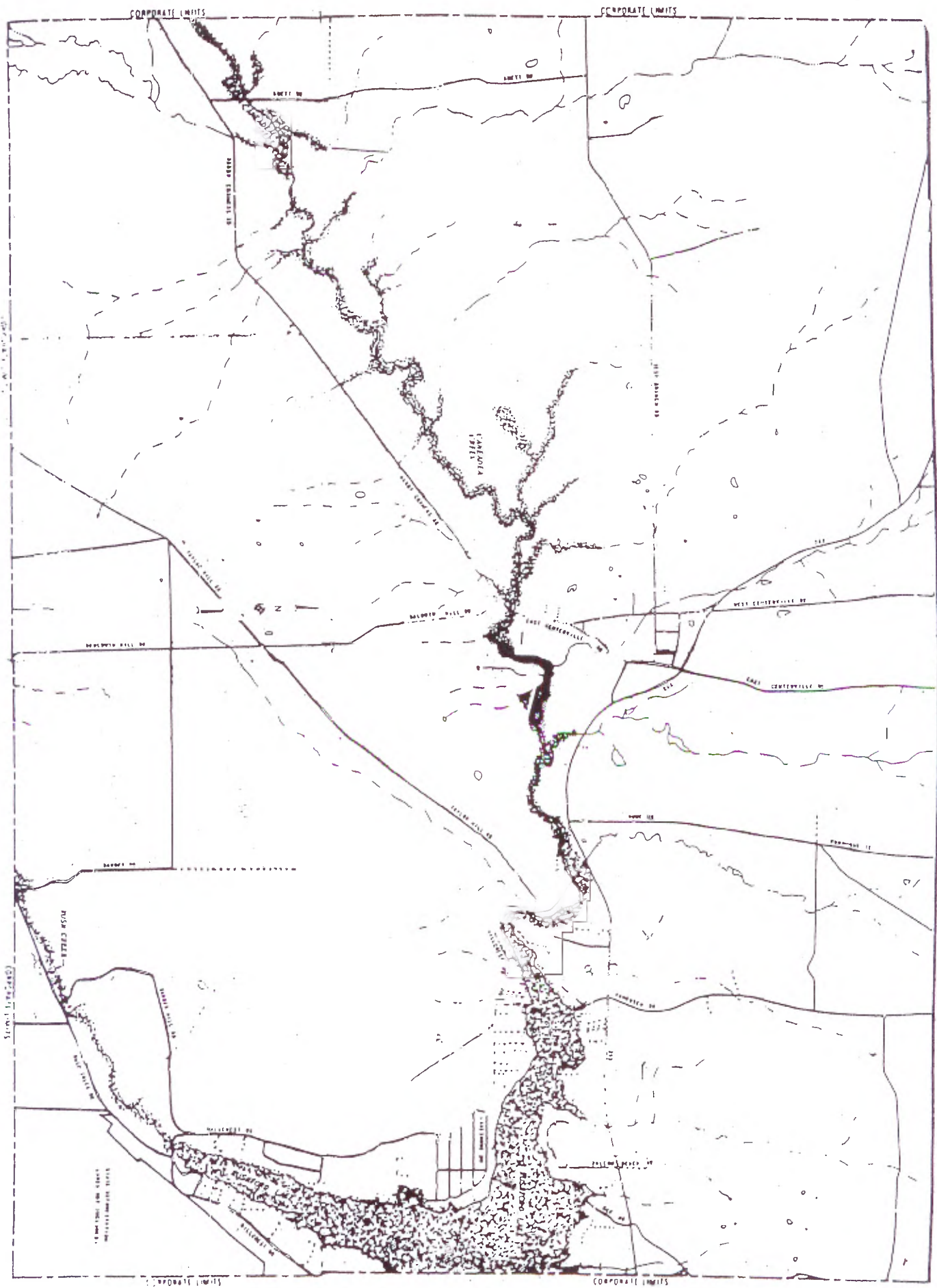
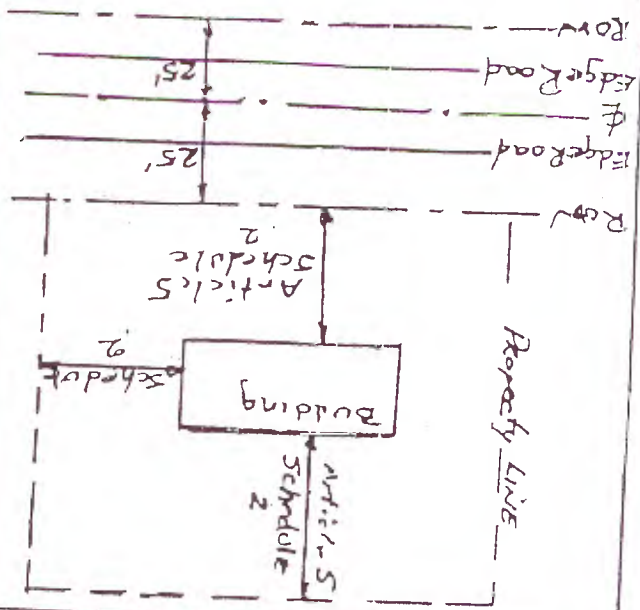
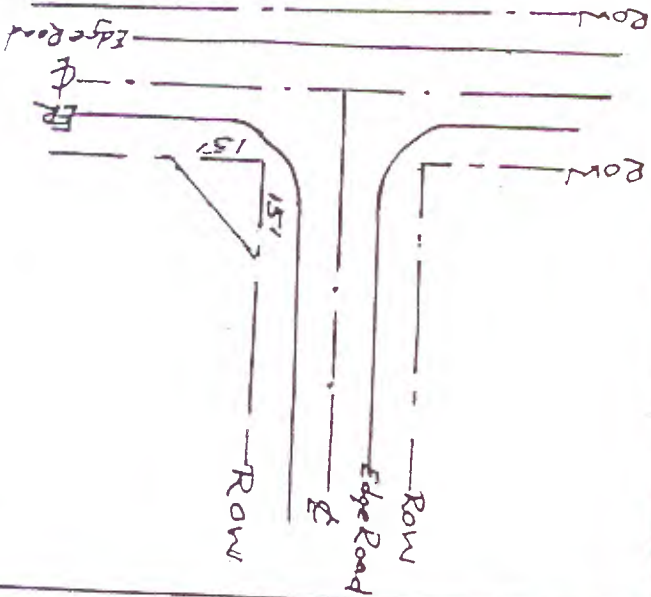

Exhibit No. 4  
Flood Hazard Area



CORNER LOTS S.R.S

SETBACK ON TOWN ROADS



LOT LAYOUT

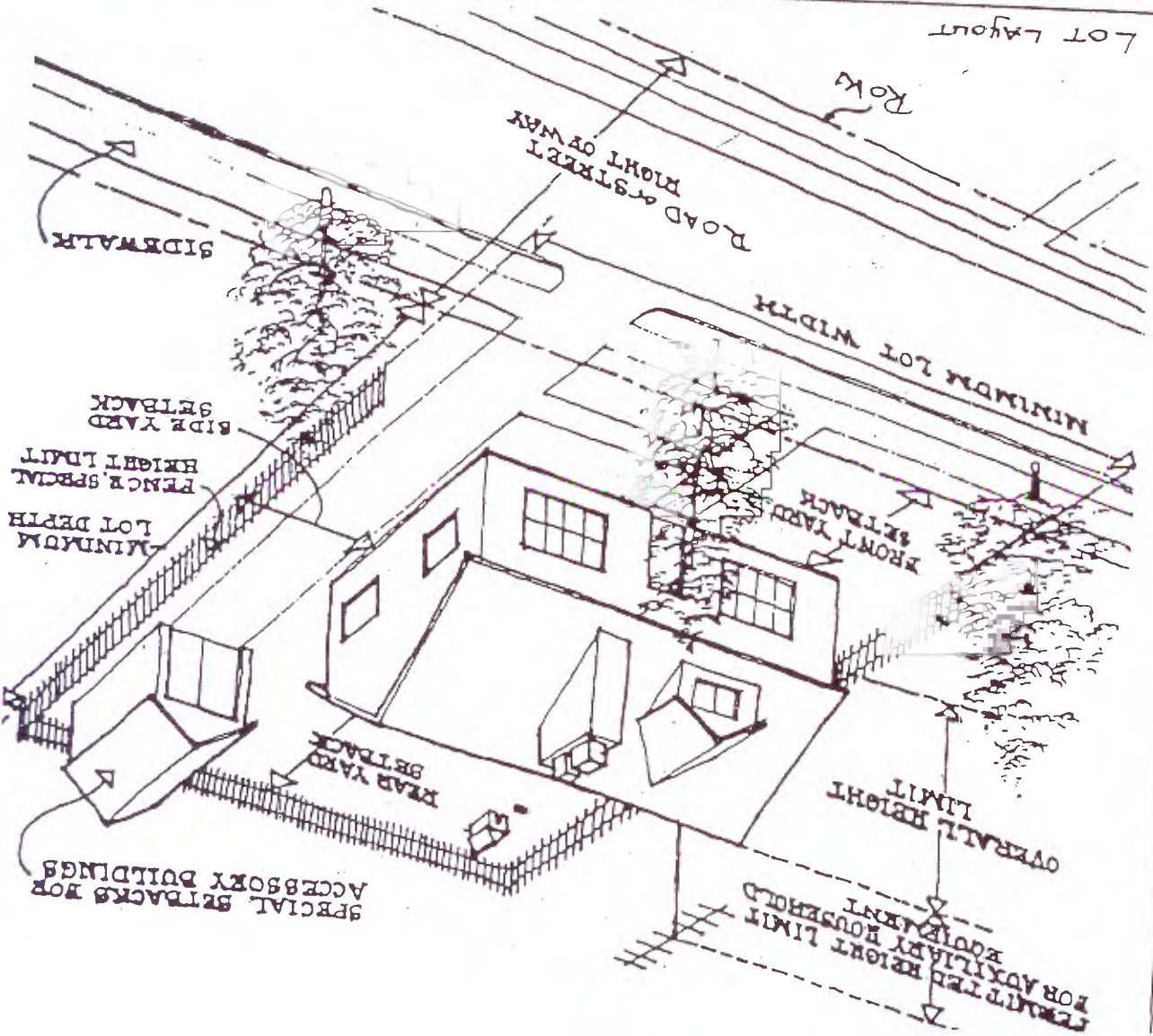

## Table of Contents

ARTICLE 1 - SHORT TITLE	1
ARTICLE 2 - INTENT AND PURPOSE	1
ARTICLE 3 - RULES AND DEFINITIONS	3
3.1 Interpretation	3
3.2 Definitions	3
ARTICLE 4 - ESTABLISHMENT AND DESIGNATION OF DISTRICTS	13
4.1 Establishment of Districts	13
4.2 Zoning Map	13
4.3 Interpretations of Boundaries	13
4.4 Districts Defined	13
ARTICLE 5 - DISTRICT REGULATIONS	16
5.1 Schedule of Regulations	16
5.2 District Use Regulations	16
5.3 Permit Regulations	17
5.4 District Use Regulations	22
ARTICLE 6 - SUPPLEMENTARY LOT REGULATIONS	23
6.1 Non-conforming Lots of Record	23
6.2 All lots	24
6.3 Recreational Trailers or Campers	25
6.4 Height Regulation	25
6.5 Yard Regulations	25
6.6 Maximum Coverage	25
ARTICLE 7 - MOBILE HOMES AND MOBILE HOME PARKS	26
7.1 Intent of this Article	26
7.2 Regulation for Mobile Homes	26
7.3 Regulations for Seasonal Use Mobile Homes	27
7.4 Mobile Home Parks	27



ARTICLE 7A - ADULT USES	32
7.1 Intent of this Article	32
7.2 Uses permitted; restrictions	32
7.3 Inspection Requirements	32
7.4 Violations	33
7.5 Enforcement; penalties for offenses	33
ARTICLE 8 - NON-CONFORMING USE AND BUILDINGS	35
8.1 Discontinuance of Use	35
8.2 Change of Use	35
8.3 Repairs and Alterations	35
8.4 Restoration	35
8.5 Replacement of Buildings/Structures	36
8.6 Razed Buildings/Structures	36
8.7 Unsafe Structures	36
ARTICLE 9 - SUPPLEMENTAL REGULATIONS	37
9.1 Automobile Graveyards and Junkyards	37
9.2 Minimum Building Size	38
9.3 Temporary Buildings	38
9.4 Unsafe Buildings / Structures	38
9.5 Extraction of Stone, Gravel, Sand, Top Soil - Commercial Use	39
9.6 Extraction of Stone, Gravel, Sand, Top Soil - Private Use	40
9.7 Sanitation	41
9.8 Signs	41
9.9 Gasoline stations / Automobile Repair Shops	41
9.10 Bulk Fuel Storage	44
9.11 More Than One Principal Structure	44
9.12 Exceptions to Height Regulations	44
9.13 Performance Requirements	45
9.14 Regulation for Floodway	45
9.15 Agricultural Animal Waste Facilities	47
9.16 Satellite Dishes	47
9.17 Sanitary Landfills	47
9.18 Used Car Lots, Mobile Home/Trailer Sales	49

ARTICLE 10 - RECREATIONAL VEHICLE CAMP OR PARK	50
10.1 Location	50
10.2 Filing application for a permit	50
10.3 Space Requirements	50
10.4 Access Road	50
10.5 Water Supply	50
10.6 Sewage System	50
10.7 Surface Drainage	50
10.8 Waste Disposal	50
10.9 Toilet/Lavatory Facilities	50
 ARTICLE 11 - ADMINISTRATION AND ENFORCEMENT	 51
11.1 General Procedure	51
11.2 Permit Types	51
11.3 Procedure for Issuing a Permit	51
11.4 Code Enforcement Officer	52
11.5 Planning Board	56
11.6 Method for Appeals	58
11.7 Permit Fees	60
 ARTICLE 12 - AMENDMENTS	 62
12.1 Town Board May Amend	62
12.2 Review by Planning Board	62
12.3 Public Notice and Hearing	62
 ARTICLE 13 - REFERRAL	 63
13.1 Mandatory Referral	63
 ARTICLE 14 - SEPARABILITY	 64
14.1 Separability	64
 APPENDIX A - LOCAL LAW NO. 1 OF THE YEAR 1986	 65
1.1 Enforcement	65